



vaellan[®]
VEHICLES

OWNER'S & SERVICE MANUAL

(Read before operating)

NORTH-AMERICA MASTER IMPORTER & DISTRIBUTOR:

Metsa Machines
DISTRIBUTOR/IMPORTER
Phone/Fax: 888-848-4842
info@metsamachines.co
PO Box 502 Merrill, WI 54452
www.metsamachines.com

MANUFACTURED:

Vaellan, Naattiantie 1, 40520 Jyväskylä, Finland
support@vaellan.com

vaellan.com



Important information about VAELLAN products

This manual will help you understand the features of the new Vaellan product and how to use the device safely. This manual also contains all the necessary safety instructions. The user manual also tells you what to consider when driving and how to maintain your device.

IMPORTANT! FAILURE TO READ AND NON-COMPLY WITH THE WARNINGS AND NOTICES IN THIS MANUAL MAY RESULT IN SERIOUS PERSONAL INJURY OR EVEN DEATH. Always read the following notices very carefully:

WARNING: Failure to read and follow this manual can result in very serious injury or even death to the user, bystander, or person repairing the device.

NOTICE: This is a tip on how you can do something easier and better.

IMPORTANT: THIS DEVICE IS DESIGNED FOR OFF-ROAD USE. USING THE APPLIANCE ON PUBLIC ROADS IS ILLEGAL AND DANGEROUS. CHECK YOUR OWN REGIONAL LAWS FOR USING THE APPLIANCE. THE EQUIPMENT SHOULD BE INSURED AND REGISTERED IF IT IS USED OUTSIDE THE CLOSED AREA FOR EXAMPLE.

CONTENTS

WARNING SIGNS	4
SAFETY INSTRUCTIONS	4
STRUCTURE AND FUNCTIONING OF THE PRODUCT	6
INTENDED USE OF THE PRODUCT	6
INTRODUCTION	6
SNOW & SNOW+ QUICK GUIDE	8
VAELLAN ATVQUICK GUIDE	9
ASSEMBLING THE TRACK UNIT (SNOW & SNOW+)	10
ENGINE/TRACK PACKAGE	10
FRAME PACKAGE ASSEMBLY	11
THE ENGINE/TRACK PACKAGE INTO THE FRAME PACKAGE	12
CONNECTION OF WIRING HARNESS	12
BATTERY	13
OTHER OPTIONS	13
PRECAUTIONS BEFORE STARTING THE ENGINE	14
STARTING AND STOPPING THE ENGINE	14
STARTING A NEW ENGINE	15
STORING THE UNIT	15
DRIVING AND OPERATING VAELLAN VEHICLE	16
OPERATING IN EXTREME CONDITIONS AND TOWING	16
SELECTING THE MAXIMUM SPEED BY CHANGING GEARS	17
Changing sprocket:	17
ATV OPTIONS AND COMBINATIONS	17
Fitting tires:	17
MAINTENANCE	18
Perform the following steps daily:	18
Perform the following steps after every 10 hours of operation:	18
Perform the following steps after every 50 hours of operation:	18
Track tension adjustment:	18
MAINTENANCE MEASURES TO BE TAKEN AT THE END OF THE DRIVING PERIOD	18
TECHNICAL DATA	19
WARRANTY	20
DISPOSAL OF THE PRODUCT	20

WARNING SIGNS

Read, understand, and follow all warning signs in manual and attached to the device. Warnings contain important safety information and proper use of the device. Never remove any safety / warning markings/stickers from your unit. If any label wears out or comes off, ask your dealer for a new label.

SAFETY INSTRUCTIONS

THE VAELLAN PRODUCT IS NOT A TOY AND IT CAN BE DIFFICULT TO OPERATE WITHOUT PROPER TRAINING. VAELLAN PRODUCTS behave differently from other vehicles such as ATVs, motorcycles and cars. A crash or incident may occur suddenly, when turning, driving on a slope, or over obstacles unless you prevent the situation properly. **SERIOUS INJURY OR DEATH** may result if you do not follow these instructions:

- Read this manual and all warning signs carefully and follow the driving instructions described.
- Never drive or allow others to drive the VAELLAN product under the influence of alcohol, drugs or narcotics, or if you do not feel healthy.
- Always wear a helmet and protective gear when driving.
- The kill switch must always be firmly attached to your clothes before starting the engine.
- Always start the product without the chain on the sprocket.
- The product may only be used by persons over 18 years of age. Check any local laws for ATV's and snowmobiles. Follow local laws.
- Never carry or haul a passenger with a VAELLAN product, the device is intended for one person only.
- Never drive the VAELLAN product on roads or other public roads. It is intended on flat surfaces and closed areas only. Do not operate VAELLAN product near other people.
- Do not start the engine if it is not fully assembled in the Vaellan unit.
- Do not remove or install any parts or assemblies while the engine of the VAELLAN Product is running.
- Always drive carefully, especially in unfamiliar terrain/flat surface. Always be vigilant while operating the unit. When driving on ice, always make sure in advance that the ice is strong enough and that there are no grooves, ditches or streams in the route. Do not drive so far into the terrain that you will not be able to walk back.
- Always follow the correct procedure for turning. Practice turning at slow speeds before turning at higher speeds. When turning at higher speeds, the VAELLAN product may tip over. Always maintain safe speed.
- Always keep both hands on the handles and both feet on the footrests when driving. Always keep your feet inside the foot rests.
- Always visually inspect your VAELLAN product before driving to make sure it is safe to drive. Always follow the maintenance instructions described in this manual.
- Never attempt any tricks, jumps or other dangerous abnormal driving habits.
- Never drive too fast for your skills or conditions. Always drive at a speed that is appropriate for the terrain, visibility and your driving skills.

- Never exceed the specified load capacity of the VAELLAN product. The load must be properly loaded and securely fastened. Reduce speed as you pull the load behind you. Do not use other than purposely built for Vaellan trailers or sleds.
- Never alter the product or use third party options.
- Do not tilt the engine beyond the tilt angle specified in the specifications to prevent damages to engine.
- Do not touch the engine exhaust or muffler after use. It may cause injury.
- Never use the VAELLAN product on slopes.
- Check the terrain carefully before driving. Never drive over rocks, stumps, fallen trees or areas that you are unfamiliar with. Sharp sticks, rocks etc., can damage the track or other parts of the product.
- Always use original spare parts, other replacement parts may not be dimensioned to meet the required characteristics and may cause damage and voids the warranty.
- Always be careful when stopping with the unit, product may still slide. Learn safe handling in case of track or tire slipping. Training first at slow speeds and flat surfaces. Drive slowly on slippery surfaces such as ice and be very careful not to lose control of the device.
- Always switch off the engine before refueling your VAELLAN product (applies to the Honda engine versions). Be careful not to spill fuel, the fuel will melt paint and plastics. Avoid skin contact. Refueling should be done in a well-ventilated area. Fuel vapors should not be inhaled. Do not start or operate the engine indoors.
- Cover hood is made only for snow, ice or below freezing conditions. Never use the cover hood in summer as the engine may overheat.
- Always make sure all bolts, fixing points and other handles are firmly tightened correctly before operating the vehicle. Make sure to attach the main frame bolts firmly before operating the Snow or Snow+ version.

STRUCTURE AND FUNCTIONING OF THE PRODUCT

The product is built on a track frame or rear axle on which the motor is mounted. The frame is made from metal pipes that are attached to the track frame or rear axle with hook-like fasteners. The unit consist of multiple different pieces that can be attached to each other easily. Notice you can use the unit with optional tires, tracks, skis or combination of these. If you are uncertain how to assemble the unit correctly please contact your local dealer or importer.

From the motor, power is transmitted to the roller or wheels by chain drive. The centrifugal clutch integrated in the engine makes the driving experience comfortable, the speed is adjusted with one throttle grip. The brake is made of a hydraulic braking system and operated from the handlebar. Always when unit is stopped use the park brake. Never leave the unit unattended when engine is running.

INTENDED USE OF THE PRODUCT

The product is intended as a vehicle for snow, ice and terrain on flat surfaces. It is not intended to be used for competition, for example, to perform various tricks, to be used in very deep snow, and it is not intended to be attached to accessories that are not designed by the manufacturer. The device is designed to operate at temperatures of + 40°C - (-20°C) or 104°F - (-4°F) and below 1500m/4900ft above sea level. The device can be driven on snow-free terrain if it is fitted with a separately sold set of tires. Driving in snow-free terrain on a track model can wear out parts faster if driving on hard or eg. sandy surfaces. When driving on snow-free terrain, care must be taken that, for example, stones do not hit any of the critical parts of the unit like to chain driven wheels or, for example, stones cannot cause severe impacts on the track or other structures. In the wheel model, you must take care that any foreign objects eg. stones do not hit the critical structures and cause severe impacts. Please note that the Vaellan unit contains wearing parts and are not included in the warranty. These wear parts needs to be serviced and replaced when necessary. Do not use the device with defective parts.

WARNING! VAELLAN product must not be used on public roads or public areas, check your local laws.

WARNING! VAELLAN product must not be used on thin ice..

NOTICE! Do not run the engine for more than one minute at low speed while loading the engine. This causes the centrifugal clutch plates to overheat and results in rapid wear of the friction plates which is not covered by the warranty.

INTRODUCTION

VAELLAN is designed to be as simple as possible in both structure and use. The use of VAELLAN requires compliance with the owner's and service manual. Each user must read and understand the operating manual before using VAELLAN vehicle.

VAELLAN's product can be transported easily by vehicle. Assembly takes place largely without tools in a matter of minutes and the unit can be changed between ATV, snowmobile and combination of these units.

NOTE! The options purchased with the VAELLAN product may require installation for the first time and may require some tools. Examples: towing hitch, snow guard, etc.)

VAELLAN PRODUCTS AND OPTIONS

- 1 Vaellan Snow
- 2 Vaellan Snow with electric start
- 3 Vaellan Snow+
- 4 Vaellan Snow+ with electric start
- 5 Vaellan ATV and ATV with electric start
- 6 Front grab
- 7 Lower engine protection bar
- 7 Lower engine protection bar for Snow+
- 8 Top engine protection bar
- 9 Towing hitch
- 10 Snop flap
- 15 Sled
- 16 Sled cover
- 12 Sprocket 12 teeth - power
- 13 Sprocket 14 teeth - regular
- 14 Sprocket 16 teeth - speed
- 17 Ski track maker
- 18 ATV front wheels 2x
- 19 ATV rear wheels and rear axle with gearbox
- Snow track
- Snow+ track
- 11 Skis (pair)
- 20 Spare key

Vaellan Snow

1,2



Vaellan Snow +

3,4



Vaellan ATV and ATV with electric start

5

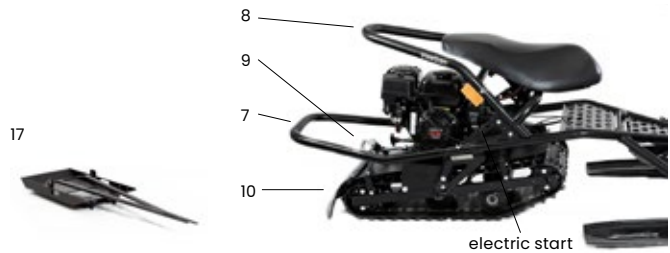

19



Comes with back wheels, rear axle, gear box. (D, N and R) - Easy to attach to any Vaellan frame.

18



Front wheels with easy fit to Vaellan frame. Can be bought separately and can be used either ATV back wheels or with track.

Sled and sled cover

16



15

15



15



Regular Vaellan Snow track fits perfectly to sled and can be hauled in the sled. Also prevents melting snow getting in to your vehicle while in transportation.

20



14



Sprockets

13

12

SNOW & SNOW+ QUICK GUIDE



1.

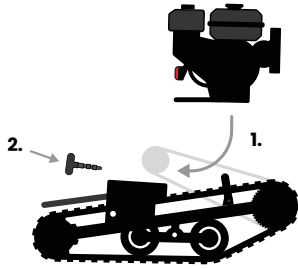

Place the motor between the guide rails on the motor stand. Push the threaded rod through the hole in the engine mount. Place the chain on the sprockets and fasten the engine tensioner T-handle.

2.

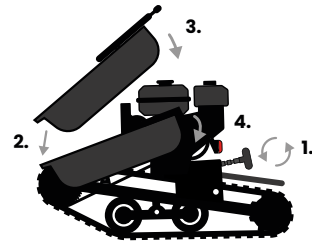

Tighten the chain by turning the T-handle until the chain feels firm. Do not over tight it (movement should be approximately 10mm from center point). Install the chain guard and tighten it with the rubber collar. Driving without chain guard is prohibited and may cause injury.

3.

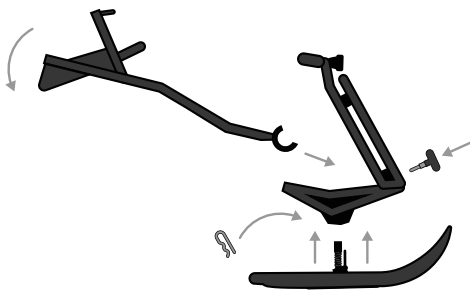

Lift the handlebar into upright position and lock it in place with the T-handle. Attach the mid frame onto the front frame. Attach the skis to their respective holes and secure them in place with a short pin.

4.

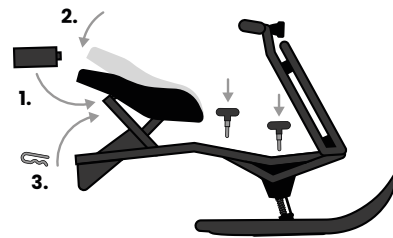

Secure the mid frame and front frame with the two T-handles. Insert the battery under the bench (battery terminals facing up). Secure battery with rubber collar. Place the bench on top of the battery and secure it with the long pin. Place the battery cable over both bench frame tubes and attach it to the red socket. Attach wire and brake cable.

5.

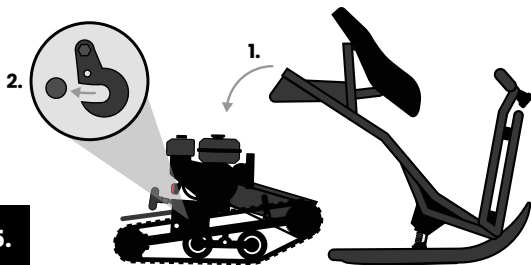

Connect the frame to the track package by lowering the frame hooks into the pins in the track package. Please use the bolt on the hooks to fully secure the frame in place to prevent any damages.

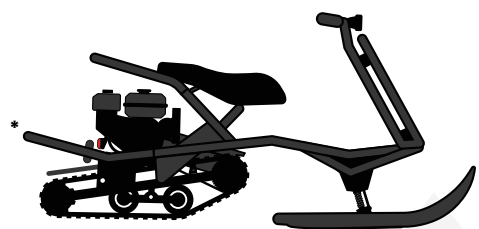

Always read the operating and maintenance instructions before use. For more information, see www.vaellan.com/support. If necessary, contact your local dealer or Vaellan Support.

* Vehicle in the picture may have optional accessories.

VAELLAN ATV QUICK GUIDE

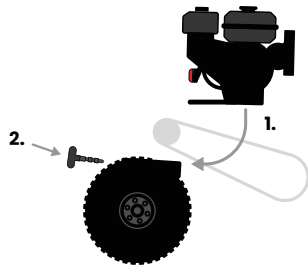

1.

Install the parts in flat and hard surface. Support the wheel package and prevent the wheels from spinning. Place the motor between the guide rails on the motor stand. Push the threaded rod through the hole in the engine mount. Place the chain on the sprockets and fasten the engine tensioner T-handle.

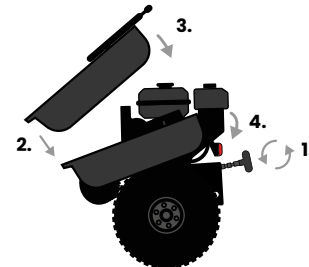

2.

Tighten the chain by turning the T-handle until the chain feels firm. Do not over tight it (movement should be approximately 10mm from center point). Install the chain guard and tighten it with the rubber collar. Driving without chain guard is prohibited and may cause injury.

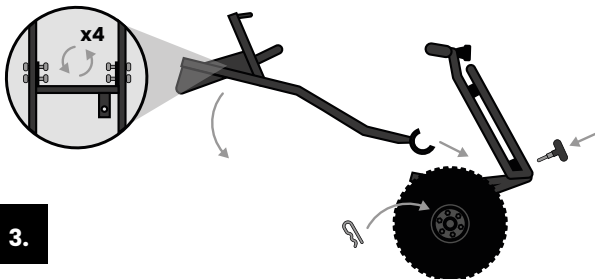

3.

Lift the handlebar into upright position and lock it in place with the T-handle. Attach a crossbar to the mid frame with 4 M12 bolts. Attach the mid frame onto the front frame. Attach the skis to their respective holes and secure them in place with a short pin.

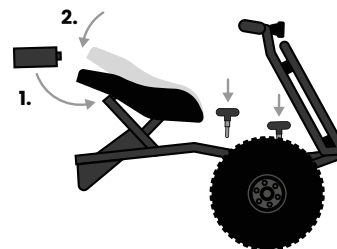

4.

Secure the mid frame and front frame with the two T-handles. Insert the battery under the bench (battery terminals facing up). Secure battery with rubber collar. Place the bench on top of the battery and secure it with the long pin. Place the battery cable over both bench frame tubes and attach it to the red socket. Attach wire and brake cable.

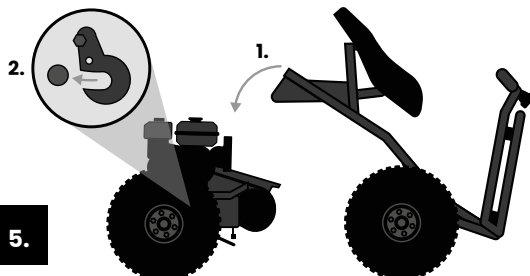

5.

Connect the frame to the motor package by lowering the frame hooks into the pins in the motor package. Please use the bolt on the hooks to fully secure the frame in place to prevent any damages.

NOTICE! Axle and the motor package need to be level while connecting.

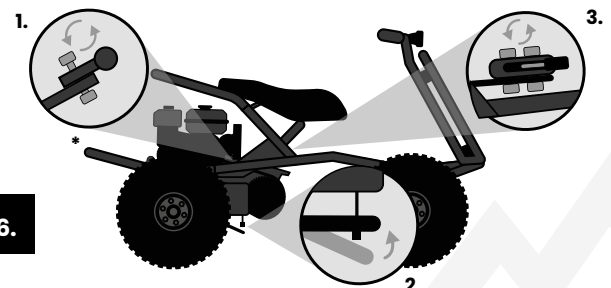

6.

1. Attach motor packages right side support to the frame with a bolt. 2. Attach a bar to the brake cylinder. 3. Attach gearshifter to its place in the crossbar. Always read the operating and maintenance instructions before use. For more information, see www.vaellan.com/support. If necessary, contact your local dealer or Vaellan Support.

* Vehicle in the picture may have optional accessories.

ASSEMBLING THE TRACK UNIT (SNOW & SNOW+)

NOTICE! Do not use excessive force when tightening the screw connections! Be sure to follow the assembly instructions and other instructions in the manual. Failure to do so will shorten the life of the device and voids the warranty.

Vaellan product can be assemble and disassemble for storage and transportation. It consists of track and engine part and the frame part. You need to assemble these units separate and finally attach them together.



Fig 1

ENGINE/TRACK PACKAGE

- Place the motor between the guide rails on the motor stand by pushing from front to back. Notice the engine thread goes through the hole. (Fig. 2).
- Add chain cover and test engine before attaching the chain
- You may need to adjust the engine
- Place the chain on the motor sprocket and on the track frame sprocket
- Push the motor between the rails so that the chain gets tighter.
- Install the Chain Guard in its proper place. (Fig. 3). Testing the engine and driving without chain guard is prohib-



Fig. 2

ited. Chain cover is secured with the black rubber strap.

- Tightening the chain for proper tightness rotate the Engine T-handle (shown Fig. 4) until the chain is able to move 10mm in the middle of the chain. Do not over tight the chain. After proper chain tight you can lock it in place with the black rubber strap.)



Fig. 3

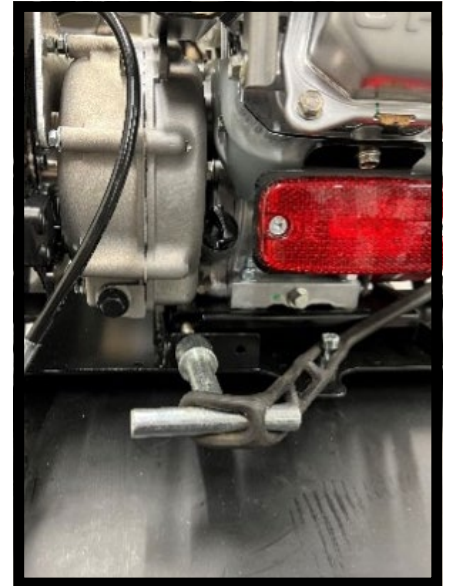

Fig. 4

CAUTION! Do not tighten the chain using tools. The new chain may stretch on first use. Check the chain tension after the first runs.

FRAME PACKAGE ASSEMBLY

- Figure 1 shows you the frame pieces. Place the front frame (# 2) on the ground and raise the handlebar. Secure the handlebar in place with the t-handle screw on the bottom of the handlebar (Fig 5). Lift the mid frame (# 3) onto the front frame into the front frame (#2) (Fig. 6).
- Secure the center frame (# 3) and front frame (# 2) firmly with two t-handles (Fig 7).
- Then attach the skis to the appropriate holes. Secure the skis by pushing them down and visually check that skis lock in place.



Fig. 5



Fig. 6



Fig. 7



THE ENGINE/TRACK PACKAGE INTO THE FRAME PACKAGE

Connect the frame package to the motor package by lowering the hooks on the center frame onto the pins in the track package. Notice the locking hole. Add locking bolts to this to prevent hooks to open. Do not operate the unit without the locking bolts. (Fig. 8).



Fig. 8

Fig. 9

Attach the Swing limiter to the mid frame, lock it to the mid frame with the locking lever (Fig. 9). Check that the swing limiter moves freely on its rail. Loosen the adjusting nut if necessary.

CONNECTION OF WIRING HARNESS

ATTENTION! Thread the brake cylinder and electric wire connector through the hole in the mid frame before connecting them. (Fig. 10)



Fig. 10

- Attach the electric wire connector to the connector on the motor. The electrical connector is placed in its corresponding grooves and rotated into place.
- Attach the brake cylinder to the brake caliper next to the gear.
- Attach the brake cable(s) to the brake bracket next to the sprocket or ATV model, next to the both wheels.
- Attach the brake cylinder to the brake caliper. Insert the brake cylinder pin into the brake caliper groove. (Fig. 11).
- Check that the brake returns to normal and does not drag, adjust if necessary, with the aluminum adjustment screw. The brake cylinder needle should move about 12mm.



Fig. 11

BATTERY

Battery is installed under the bench and tightened in place with the supplied strap (Fig. 12). Install battery tight enough to prevent the battery from moving due to vibration. If the battery gets rubbed into metal structures, its shell may burst and corrosive battery acid may leak out. Always remember to store the battery upright and fully charged. The battery may discharge if left out for a long time.



Fig. 12

OPTION! Vaellan battery Charger is convenient way to charge your Vaellan battery.

OTHER OPTIONS

The engine protection bars and the front grab are mounted with the provided clips. Please note that arches cannot withstand sitting.

The splash guard is mounted with the supplied bolts.

The towbar is mounted with the supplied bolts. Please note that Snow and Snow + as well as ATVs have their own separate towbars.

KILL SWITCH

Connect the end of the kill switch to the mount in the handlebar (Fig. 13). The kill switch must be installed each time the engine is started. The engine shuts off when the clip is pulled off. Always fasten the safety device to your clothes before starting the unit. Do not operate unit without proper use of kill switch.



Fig. 13

PRECAUTIONS BEFORE STARTING THE ENGINE

1. Before starting a new engine, make sure that the engine oil and transmission oil are filled to the correct level. Check also that fuel tank is refueled. Do not over fill.

2. The correct engine oil must be used for the engine and gearbox according to the operating temperature, see technical data. If, in cold conditions, the electric start cannot give the engine a high enough speed to start, start the engine using a start rope.

When checking the oil level with the dipstick, turn the dipstick fully closed to get the correct reading. Remember that different types of oil must not be mixed together, mixing may cause the oil to settle in the engine, causing engine damage. Using wrong oil voids warranty.

3. Fill the engine fuel tank with E98 octane or higher quality. Note that using wrong fuel may not work very well in severe frosts. Do not fill the tank completely, otherwise fuel will spill over the tank during use and transport. Fill the tank to the mark / collar shown in the tank.

4. If you notice a fault or damage to the device. Do not use the machine and contact your authorized dealer.

5. Always start the engine without the chain and with the chain cover on before operating the unit.

STARTING AND STOPPING THE ENGINE

Always attach the kill switch to your clothing before starting the unit. Check that the hydraulic brake is correctly installed in the brake position near the engine sprocket. Check that the hydraulic fluid is in correct level and it is functioning correctly.

Check throttle and brake lever operation and they both move freely and both return to right position. **If either of these does not happen, the engine must not be started!** Always clean any ice or snow from the engine before starting. Check the brakes also in slow speeds before increasing the speed. If the throttle lever is damaged in the wrong position, it can cause a sudden start after starting – always start the engine without the chain and chain cover installed. For example, the throttle lever may be

frozen and cause the unit to start moving without operating the throttle lever. If the linkage does not work properly, the engine should be warmed up and allowed to dry. Do not use machine if you suspect damage to throttle or brake system. Contact your local authorized dealer.

Open the fuel tap and, if necessary, switch on the choke (Fig. 14). In the electric start version, apply the brake at the same time as starting the device with the key. In the case of a non-electric starter, pull the start lever while applying the brake.

Allow the appliance to warm up for a while and then close the choke.

To start, press the lower lever with your thumb (Fig. 15). Breaking is done by pulling the break lever shown in the figure above (Fig. 16). The brake can be locked to parking brake by adding the black rubber strap on end of the brake.



Fig. 14



Fig. 15



Fig. 16

NOTE! Prolonged engine idling (more than 15 minutes) should be avoided.

NOTE! If water gets into the fuel, it will cause malfunctions and may freeze in the carburetor, preventing starting.

NOTE! Driving on the choke results in higher fuel consumption and scorching the spark plug. The choke must be turned off immediately after starting.

NOTE! If the engine starts to smoke and feels inefficient - clean the engine air filter.

NOTE! To turn off the engine, remove the kill switch or press the kill switch or turn the key to turn off the engine. You can also shut down the engine by pressing the middle button on the switch board. When the engine is switched off, the fuel tap must be closed.

NOTE! Disconnect the battery quick connector if the unit is not used for several hours.

STARTING A NEW ENGINE

The new engine must have a "run in". Running-in ensures a long engine life. During driving, use of full power should be avoided and all driving should be in slow gear. The run-in must take at least 2 tanks of fuel. In most engines, the engine idle needs to be adjusted during running-in. The idle adjustment is made from the black Phillips screw in the carburetor (Fig. 17).

STORING THE UNIT

Disassembly takes place in reverse order. Remember that the motor and the battery must be kept upright.



Fig. 17

NOTICE! Engine might be hot after use.

DRIVING AND OPERATING VAELLAN VEHICLE

Always check before starting to operate the VAELLAN VEHICLE that all parts are fastened together and locked by bolts and T-handles as instructed. Check the operation of the lights and the condition of the reflectors. Check the operation of the brakes and parking brake. Check the operation of the motor kill switch, the motor should stop when the clip is pulled off. Also check the operation of the steering when the engine is idling by turning the steering to its extreme positions. At the same time, check that the engine is idling. Check that the skis are locked in place.

Always use lights. The operating switch can be found on the handlebar. Also switch for horn and main power switch is located next to light switch.

Take a comfortable position on the seat and place your feet in the spaces provided on the front frame. Do not have feet outside of the vehicle while driving, it may cause injury. Slowly press the throttle lever on the handlebar the engine speed will start to increase and at the same time the machine will start moving. The speed of the device changes in proportion to the engine speed. The appliance stops when you release the gas or use the brake. When driving the unit, sit on the bench and keep both hands on the handlebar for safety reasons.

For safety reasons, do not connect devices other than those approved by VAELLAN.

OPERATING IN EXTREME CONDITIONS AND TOWING

If the machine sinks into deep snow, immediately remove the wet snow between the track and the rest of the machine. Do not push the Vaellan vehicle from the handlebar to avoid handlebar damage.

If snow has gotten between the starter cord and the starter cord is frozen, do not try to force the cord or it may break. Remove the starter cord housing and clean the cord. Always use the electric starter first.

If, despite the measures, the vehicle cannot be started or cannot be driven, towing at a speed of up to 5 km/h (2 mph) can be carried out as follows:

1. Remove the chain between the motor and the track frame or rear axle
2. If towing ATV switch gear to neutral
3. You may use the front grab for towing.
4. Pull the machine forward.

NOTICE! If you are transporting the track in a sled or similar, be aware that the melt water may remain in the sled after usage. Freezing water can damage the track body and parts.

SELECTING THE MAXIMUM SPEED BY CHANGING GEARS

With The Vaellan Vehicle, you have a choice of different maximum speeds by changing the engine gear. Unit is equipped with 14-teeth sprocket as a standard. Optional 16-teeth sprocket is used when driving on icy surfaces, frozen lakes or hard snow. Optional 12-teeth sprocket is used when towing or driving outside the trails.

Changing sprocket:

1. The engine must be switched off
2. Remove the chain from the engine
3. Remove the bolt from the engine sprocket shaft
4. Remove the sprocket by pulling it off the shaft
5. Position the new sprocket so that the sprocket is furthest from the engine. Check that key will remain in the keyway. (Some versions also have an accessory ring with the sprocket)
6. Place the sprocket mounting bolt at the end of the axle
7. Tighten the bolt

ATV OPTIONS AND COMBINATIONS

Tires can be used instead of skis when there is little snow or when driving without a snow cover. The tires are installed in place of the skis and locked in place with a pin. If a rear axle and tires are used in place of the track, it locks in place similar way as the track locks in place with mid frame.

Fitting tires:

- Remove the skis and add optional tires.
- Mount the wheels valve facing outwards. Some option tires also have a direction of rotation.
- Disassembly takes place in reverse order.
- First install the engine and the battery in the battery holder. When installing the engine, make sure that shaft is properly supported to preventing falling. Then the rear axle is attached to the same attachment points as track. After attaching the shaft, the gear selector is mounted to left side under the seat (seat frame fixing bolts). Disassembly takes place in reverse order.

MAINTENANCE

Perform the following steps daily:

- Check for any oil or fuel leaks. add / check oil and fuel level
- Check the oil level in the engine and gearbox
- Check the chain tension

Perform the following steps after every 10 hours of operation:

- Lubricate the chain with chain spray (Please note that the chain and sprocket wear out faster if lubrication is not done)
- Check the tightness of the screw connections

Perform the following steps after every 50 hours of operation:

- Tighten the plastics on the front panels
- Check the condition of the brake pads, replace if necessary.
- Check tire pressures.
- Check track tension, tighten if necessary.
- Check the chain alignment when the chain is tightened. If necessary, adjust by loosening the engine mounting bolts and turning the engine. Then tighten the bolts.

Track tension adjustment:

- Loosen the bolts on the rear axle bearing brackets
- Move the axle backwards until you get the track is not touching the track frame in the middle.
- Check the distance between the ends of the drive shaft and the folding roller shaft on both the left and right, the difference must not exceed 2 mm
- Check and tighten the bearing bracket bolts if necessary

MAINTENANCE MEASURES TO BE TAKEN AT THE END OF THE DRIVING PERIOD

- Wash and dry the appliance
- If the paint has worn at some points, sand and repaint the damaged areas. Get the right shade from your local authorized dealer.
- Check rollers and bearings on track and tires, replace if necessary.
- Service the engine. Adjust valve clearances and plug. Change oils in engine and transmission. It is advisable to have the engine serviced annually by an authorized service center. If you do the annual maintenance yourself, collect the drained oil and take it to a hazardous waste collection point. The oil is harmful to nature and should not be allowed to enter the ground.
- The device must be protected from rain in a dry place with effective ventilation due to possible fuel vapor.
- If the device is not used for a long time, charge the battery with the optional maintenance charger every three months.
- It is advisable to fill the fuel tank with alkylate petrol and then use it for a few minutes. Normal gasoline will not remain good when unused in the engine for a long time. It may cause running problems or prevent the engine from starting.

TECHNICAL DATA

Main dimensions, length/width/
height

Skis: Snow: 2100mm, **Snow+:** 2500mm/1100mm/1100mm
Front wheels: 1800mm/1180mm/1100mm
ATV: 1700mm/1180mm/1100mm

Dryweight (no options)	Snow: 109kg Snow+: 114kg ATV: 128kg
Tire pressure	0,3bar
Trailer tire pressure	2bar
Maximum load	Snow: 159kg, Snow+: 154kg, max towing capacity 110kg
Intended use	Light multipurpose vehicle for snow to off-road usage.
Operating angle	Max operating slope 20 degrees
Operating temperature	+40°C – (-15°C)
Highest operating altitude	1500m
Top speed, slow transmission selected	15km/h or 9 mph
Top speed, fast transmission selected (optional)	20km/h or 12 mph
Engine	Honda GX200
Plug tip spacing	0,8mm
Valve clearances when cold	Intake valve 0,15+-0,02mm, exhaust valve 0,20+-0,02mm
kW (hp) / RPM	4,3 (5,8) / 3600
Fuel	E98, Fuel tank 3,1l
Fuel consumption / (max)	<1l/h (1,7l/h max)
Transmission	Centrifugal clutch and chain
Noice level	<70dB(A)
Frame	Skis and tracks or 4-wheels or tracks and 2 wheels front
Suspension	Front springs and swing frame in the track
Engine oil	0,6l APISJ-SAE 10W-30 or 0W-40 (do not use over +15°C)
Transmission oil	0,5l APISJ-SAE 10W-30 or 0W-40 (do no use over +15°C)

WARRANTY

The manufacturer strives for continuous quality improvement in design and production. These guarantees quality products for end users.

This warranty applies only to manufacturing defects and defects that have occurred and are reported to the manufacturer within the warranty period. We provide a 12-month warranty on the vehicle frame from the date of purchase. The Honda engine has a 36-month warranty. Electric components have 12-month warranty.

NOTICE: The warranty only covers the parts covered by the warranty but not their installation or shipping. This warranty does not cover parts that have been damaged by improper stacking, neglect of maintenance, misuse, negligence, or self-inflicted accident.

Service must be performed by a manufacturer-authorized service center in accordance with the service schedule. The manufacturer is not responsible for travel or installation costs incurred or any other third-party costs.

What this warranty does not cover: Damage or failure caused by neglect of service, misuse of the device, negligence, use contrary to the manual, modifications to the device, accidents or if the device has been used with non-original parts. The warranty also does not cover damage caused by renting, borrowing, driving on snow-free hard ground with a track or skis, or damage caused by hitting a rock, stump, or other hard object. The warranty also does not cover defects caused by competitive use. This warranty does not cover parts that wear out during normal use, such as a spark plug, chain, track, or tires. The warranty also does not cover indirect costs or the costs of delivering the unit or part of the device for service. The warranty also does not cover the cost of shipping and packing parts when shipping parts to the customer. The warranty is only valid for the first owner who is marked as a buyer.

DISPOSAL OF THE PRODUCT

The product should be disposed of in accordance with local requirements. The engine contains oil that is dangerous to nature. The battery contains dangerous acids. Ask your local recycling center for disposal instructions.



EU DECLARATION OF CONFORMITY

Manufacturer: Vaellan Oy, Naattiantie 1, 40520 Jyväskylä
Brand: Vaellan
Model: Vaellan

We declare that the device meets the requirements of the following directives: 2006/42 / EC, 2004/108 / EC, 97/68 / EC, 2001/95 / EC and complies with the following harmonized standards: EN ISO 12100-2010.
In Jyväskylä on 15 January 2021

Tatu Virtanen
Head of R&D, Mother and Father of Vaellan products
Vaellan Oy